



# ATH-WB2022

Wireless Headphones

---

## User Manual

English

# Safety precautions

Although this product was designed to be used safely, failing to use it correctly may result in an accident. To ensure safety, observe all warnings and cautions while using the product.

## Cautions for the product

- Do not use the product near medical equipment. Radio waves may affect cardiac pacemakers and medical electronic equipment. Do not use the product inside medical facilities.
- When using the product in aircraft, follow airline instructions.
- Do not use the product near automatic control devices such as automatic doors and fire alarms. Radio waves may affect electronic equipment and cause accidents due to malfunction.
- Do not disassemble, modify or attempt to repair the product to avoid electric shock, malfunction or fire.
- Do not subject the product to strong impact to avoid electric shock, malfunction or fire.
- Do not handle the product with wet hands to avoid electric shock or injury.
- Disconnect the product from a device if the product begins to malfunction, producing smoke, odor, heat, unwanted noise or showing other signs of damage. In such a case, contact your local Audio-Technica dealer.
- Do not allow the product to get wet to avoid electric shock or malfunction.
- Do not put foreign matter such as combustible materials, metal, or liquid in the product.
- Do not cover the product with a cloth to avoid fire or injury by overheating.
- Follow applicable laws regarding mobile phone and headphone use if using headphones while driving.
- Do not use the product in places where the inability to hear ambient sound presents a serious risk (such as at railroad crossings, train stations, and construction sites).
- Do not charge the product if water or foreign matter is inside the battery jack or exclusive USB cable. Doing so may cause corrosion, heat generation, smoke, fire, or other malfunction or electric shock in the battery jack or exclusive USB cable.
- Do not charge the battery if the terminal of the exclusive USB cable is bent, loose, or damaged. Doing so may cause heat generation, smoke emission, fire or electric shock.
- When charging, make sure to use the included exclusive USB cable.
- Do not charge with devices that have quick-charge functionality (with a voltage of 5 V or more). Doing so may cause the product to malfunction.
- To prevent damage to your hearing, do not raise the volume too high. Listening to loud sound for an extended period may cause temporary or permanent hearing loss.
- Discontinue use if skin irritation results from direct contact with the product.
- Do not catch your fingers or other body parts inside the joints.

## Cautions for rechargeable battery

The product is equipped with a rechargeable battery (lithium ion battery).

- If battery fluid gets into eyes, do not rub them. Rinse thoroughly with clean water such as tap water and consult a doctor immediately.

## Safety precautions

- If battery fluid leaks, do not touch fluid with bare hands. If fluid remains inside the product, it may cause malfunction. If battery fluid leaks, contact your local Audio-Technica dealer.
  - If fluid gets in your mouth, gargle thoroughly with clean water such as tap water and consult a doctor immediately.
  - If your skin or clothing comes in contact with fluid, immediately wash the affected skin or clothing with water. If you experience skin irritation, consult a doctor.
- To avoid leakage, generation of heat or explosion:
  - Never heat, disassemble or modify the battery, nor dispose of it in a fire.
  - Do not attempt to pierce with a nail, hit with a hammer or step on the battery.
  - Do not drop the product or subject it to strong impact.
  - Do not get the battery wet.
- Do not use, leave or store the battery in the following places:
  - Area exposed to direct sunlight or high temperatures and humidity
  - Inside of a car under the blazing sun
  - Near heat sources such as heat registers
- Charge only with the included USB cable to avoid malfunction or fire.
- The internal rechargeable battery of this product cannot be replaced by the user. The battery may have reached the end of its service life if the usage time becomes significantly shorter even after the battery has been fully charged. If this is the case, the battery needs to be repaired. Contact your local Audio-Technica dealer for repair details.
- When the product is disposed of, the built-in rechargeable battery needs to be discarded properly. Contact your local Audio-Technica dealer to learn how to properly dispose of the battery.

## For customers in the USA

### FCC Notice

#### Warning

This device complies with Part 15 of the FCC Rules. Operation is subject to the following two conditions: (1) This device may not cause harmful interference, and (2) this device must accept any interference received, including interference that may cause undesired operation.

#### Caution

You are cautioned that any changes or modifications not expressly approved in this manual could void your authority to operate this equipment.

Note: This equipment has been tested and found to comply with the limits for a Class B digital device, pursuant to part 15 of the FCC Rules. These limits are designed to provide reasonable protection against harmful interference in a residential installation. This equipment generates, uses and can radiate radio frequency energy and, if not installed and used in accordance with the instructions, may cause harmful interference to radio communications. However, there is no guarantee that interference will not occur in a particular installation. If this equipment does cause harmful interference to radio or television reception, which can be determined by turning the equipment off and on, the user is encouraged to try to correct the interference by one or more of the following measures:

## Safety precautions

- Reorient or relocate the receiving antenna.
- Increase the separation between the equipment and receiver.
- Connect the equipment into an outlet on a circuit different from that to which the receiver is connected.
- Consult the dealer or an experienced radio/TV technician for help.

This transmitter must not be co-located or operated in conjunction with any other antenna or transmitter used in other systems.

### RF Exposure Statement

This device meets the U.S. Federal Communications Commission's (FCC) requirements for exposure to radio waves and is designed and manufactured not to exceed the FCC's emission limits for exposure to radiofrequency (RF) energy. To comply with FCC RF exposure compliance requirements, this device must not be co-located or operating in conjunction with any other antenna or transmitter.

### Contact

Responsible Company: Audio-Technica U.S., Inc.  
Address: 1221 Commerce Drive, Stow, Ohio 44224, USA  
Tel: 330-686-2600

## For customers in Canada

### ISED statement

CAN ICES-003(B)/NMB-003(B)

This device contains licence-exempt transmitter(s)/receiver(s) that comply with Innovation, Science and Economic Development Canada's licence-exempt RSS(s). Operation is subject to the following two conditions:

- (1) This device may not cause interference.
- (2) This device must accept any interference, including interference that may cause undesired operation of the device.

This device complies with RSS-102 radiation exposure limits set forth for an uncontrolled environment.

# Notes on use

- Be sure to read the connected device's user manual before use.
- Audio-Technica will not be liable in any way for any loss of data in the unlikely event that such losses should occur while using the product.
- On public transportation or in other public places, keep the volume low so as not to disturb other people.
- Minimize the volume on your device before connecting the product.
- When using the product in a dry environment, you may feel a tingling sensation in your ears. This is caused by static electricity accumulated on your body, not by product malfunction.
- Do not subject the product to strong impact.
- Do not store the product in direct sunlight, near heating devices, or in hot, humid, or dusty places. Additionally, do not allow the product to get wet.
- When the product is used for a long time, the product may become discolored due to ultraviolet light (especially direct sunlight) and wear.
- If the product is placed in a bag while the exclusive USB cable is still connected, the exclusive USB cable may become caught, severed, or broken.
- Make sure to hold the plug when connecting and disconnecting the exclusive USB cable. The exclusive USB cable may become severed or an accident may occur if you pull on the cable itself.
- When you are not using the exclusive USB cable, disconnect it from the product.
- This product can be used to talk on the phone only when using a mobile telephone network. Support for telephony apps that use a mobile data network is not guaranteed.
- If you use the product near an electronic device or transmitter (such as a mobile phone), unwanted noise may be heard. In this case, move the product away from the electronic device or transmitter.
- If you use the product near a TV or radio antenna, noise may be seen or heard in the television or radio signal. In this case, move the product away from the TV or radio antenna.
- To protect the built-in rechargeable battery, charge it at least once every 6 months. If too much time passes between charges, the life of the rechargeable battery may be reduced, or the rechargeable battery may no longer be able to be charged.
- Charge the product in a well-ventilated place (10 to 35°C (50 to 95°F)) away from direct sunlight. Otherwise, the battery may deteriorate, possibly resulting in shorter periods of continuous use or may fail to charge.
- If the product is wet with sweat, wipe off any moisture with a dry cloth before charging.
- Since natural wood may deform or change color under the condition like a hot, humid, dry, ultraviolet (sunlight, fluorescent) environment, be careful in these environments.
- The wooden housing may scratch or split if subjected to impact.
- The pattern of the wood grain varies on the right and left because the product is made of natural wood, but this will not affect the performance.

# For a more comfortable Bluetooth communication experience

The effective communication range of this product varies depending on obstructions and radio wave conditions. For a more enjoyable experience, please use the product as close as possible to the Bluetooth device. To minimize noise and sound disruptions, avoid placing your body or other obstacles between the product's antenna (L side) and the Bluetooth device.

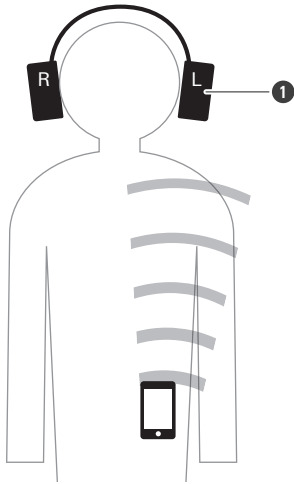

① Antenna

# Part names and functions

## Headphones

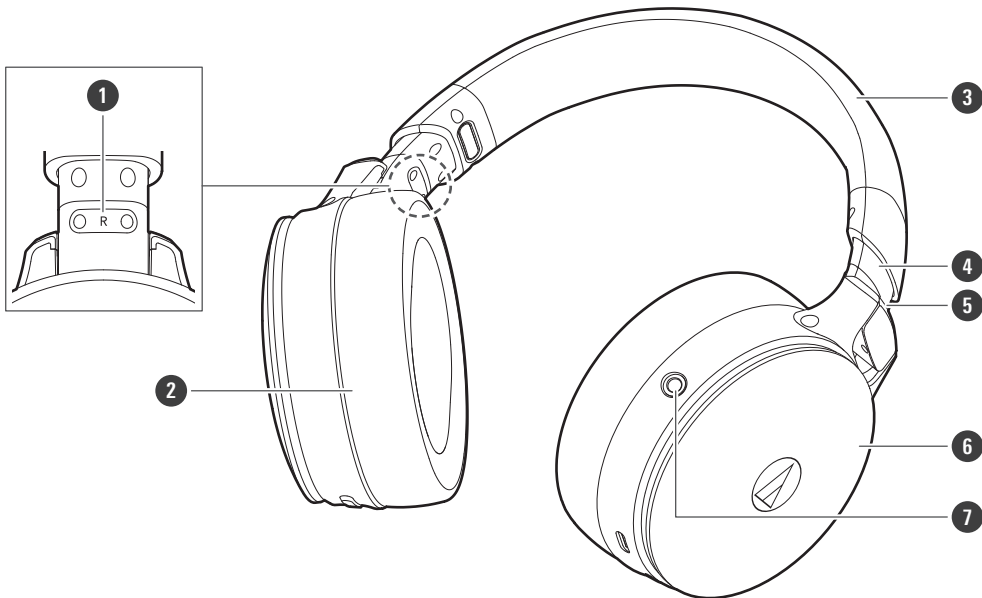

- 1 L/R (left/right) indicator
- 2 Earpad
- 3 Headband
- 4 Slider
- 5 Joint
- 6 Housing
- 7 Microphone

## Operation area (R (right) side)

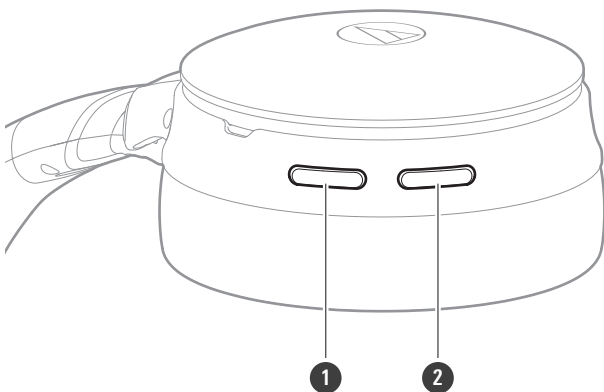

- 1 Volume button (+)
- 2 Volume button (-)

### Operation area (L (left) side)

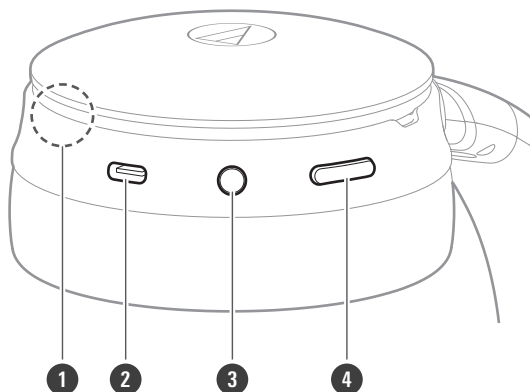

**1 Indicator lamp**

Displays the operating status and battery level of the product.

**2 Battery jack**

Use to connect the included exclusive USB cable for charging and wired connection.

**3 Power supply / control button**

Use to turn the power supply ON/OFF and USB audio mode ON/OFF.

**4 Multifunction button**

Use to play/pause music and answer phone calls.

### Accessories

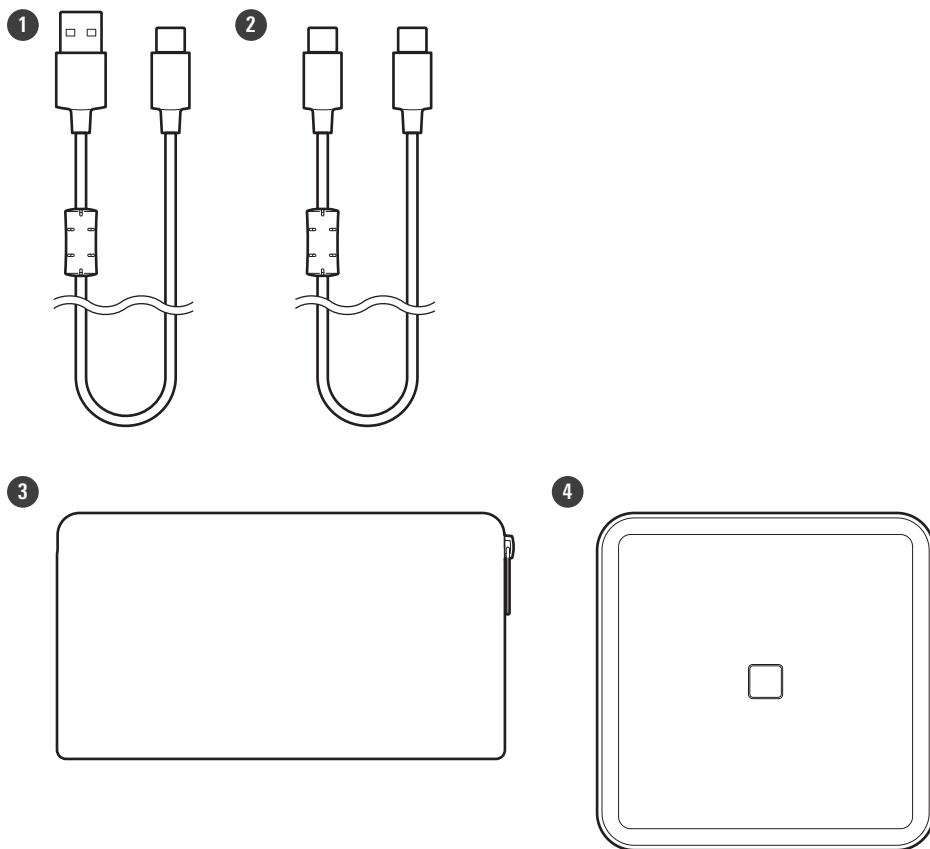

- ① Exclusive USB cable (1.5 m (4.9'), USB Type-A / USB Type-C™)
- ② Exclusive USB cable (1.5 m (4.9'), USB Type-C / USB Type-C™)
- ③ Pouch (for storing cables)
- ④ Case

# Charging the battery

- Fully charge the battery when using for the first time.
- When the rechargeable battery is running low, the voice guidance will play the message “Low battery”, and the indicator lamp will flash in white. Charge the battery as soon as possible.
- It takes about 2.5 hours maximum to charge the battery fully. (This time may vary depending on usage conditions.)
- Charge the product in a well-ventilated place (10 to 35°C (50 to 95°F)) away from direct sunlight. Charging outside the normal charging temperature range may result in failure to charge or longer charging time. Otherwise, the battery may deteriorate, possibly resulting in shorter periods of continuous use or may fail to charge.
- Use the appropriate exclusive USB cable for the connected device’s terminal (either USB Type-A / USB Type-C or USB Type-C / USB Type-C).

## 1 Connect the included exclusive USB cable (USB Type-C side) to the battery jack.

- The included exclusive USB cable is designed for exclusive use with the product. Do not use any other USB cable.
- When inserting the exclusive USB cable into the USB port or battery jack, insert it directly (horizontally).

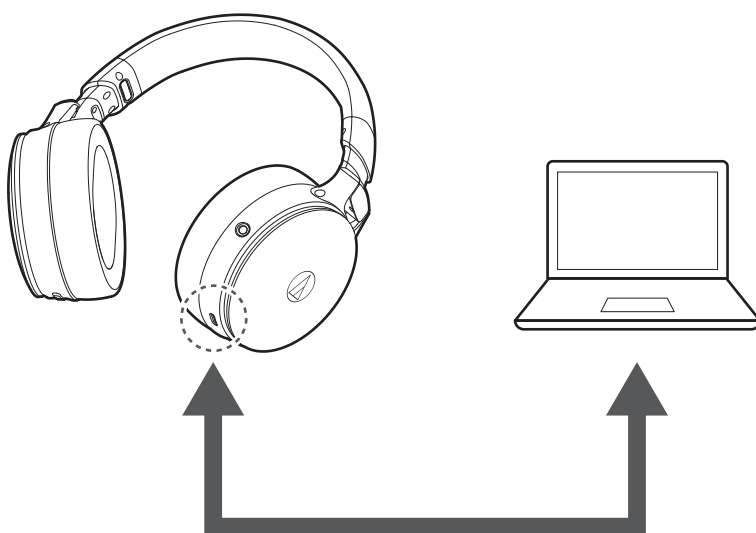

## 2 Connect the included exclusive USB cable to the computer to start charging.

- While charging, the indicator lamp lights as follows. (It may take several seconds for the indicator lamp to light.)

Indicator lamp	Status
Lights in white	Charging
Off	Charging complete
Flashing white	Charging error <sup>[1]</sup>

[1] The headphones may be hot. Allow the temperature of the product to cool sufficiently before charging in a well-ventilated place (10 to 35°C (50 to 95°F)) away from direct sunlight.

## 3 When charging is complete, disconnect the exclusive USB cable from the computer.

## Charging the battery

### 4 Disconnect the exclusive USB cable from the product's battery jack.



- If you start to charge while the product is on, it will automatically turn off.



- When charging, make sure to use the included exclusive USB cable. The product may not charge with cables other than the included exclusive USB cable.

# Power supply ON/OFF

## Turning on the product

- 1 Remove this product from the case.

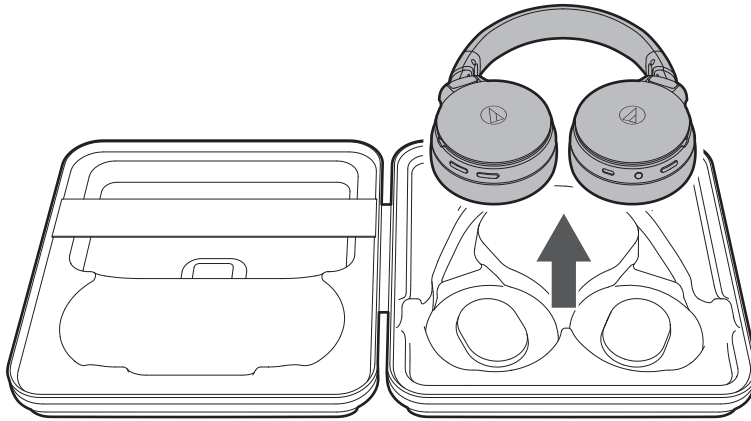

» The power will turn on automatically and the indicator lamp will light in white and then flash.  
Voice guidance is played.



- To turn on the power manually, press and hold the power supply / control button (about 2 seconds).
- It may take several seconds for the indicator lamp to light.
- See "Voice guidance" (p. 35) for more information on voice guidance.

## Turning off the product

- 1 Place this product in the case.

- If you have adjusted the headband height using the product slider, return it to its lowest setting (height at the time of purchase) before placing it in the case. Leaving the height as-is after being adjusted with the slider will make it impossible to properly place it in the case.

## Power supply ON/OFF

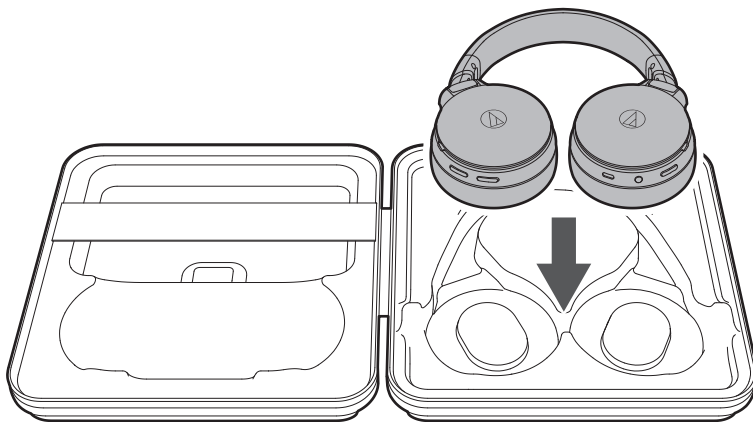

» The indicator lamp will light in white, turns off, and the power will turn off automatically.



- To turn off the power manually, press and hold the power supply / control button (about 2 seconds).

# Connecting via Bluetooth

To connect the product to a Bluetooth device, the product needs to pair (register) with the device.

## Pairing a Bluetooth device

- Read the user manual for the Bluetooth device.
- Place the Bluetooth device within 1 m (3.3') of the product to perform pairing correctly.
- Wear the product to hear voice guidance during pairing.

### 1 Starting with the product turned off, turn it on.

- The indicator lamp will light in white, and then flash in white.

### 2 Use your Bluetooth device to begin the pairing process and search for the product. When your Bluetooth device finds the product, "ATH-WB2022" will be displayed on the device.

- For information about using your Bluetooth device, refer to the device's user manual.

### 3 Select "ATH-WB2022" to pair the product and your Bluetooth device.

- Some devices may ask for a passkey. In this case, enter "0000". The passkey may also be called a passcode, PIN code, PIN number, or password.

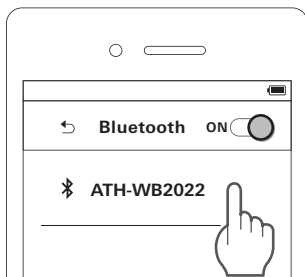

» The voice guidance will play the message "Connected", and the indicator lamp will flash slowly in white. This indicates pairing was successfully completed.

## About pairing

When connecting a new Bluetooth device, you need to pair it with the product. Once the Bluetooth device and the product are paired, you do not need to pair them again. The product supports multipairing, in which a connection history is saved. However, in the following cases you will need to pair again even if the Bluetooth device was paired once:

- If the product is deleted from the Bluetooth device's connection history.
- If the product is sent out for repair.
- If the product is reset.

### Multipoint function

The product supports multipoint, which allows two Bluetooth devices to be connected at the same time. While you are listening to music with one device, you can answer a call that comes in from the other device. It is convenient if you have two smartphones, for example.

- Audio-Technica does not guarantee the operation of all combinations of Bluetooth devices.

#### Connecting using multipoint

- 1 Pair with the first Bluetooth device.**
- 2 Pair with the second Bluetooth device within 30 seconds of pairing with the first Bluetooth device.**



- If the product does not connect, restart its power.
- Up to two Bluetooth devices can be connected at the same time with multipoint. To connect a third Bluetooth device, disconnect one of the connected devices.
- Music cannot be played back on two devices at the same time.

# Wearing the product

Put the side of the product marked “L” (LEFT) onto the left ear and the side marked “R” (RIGHT) onto the right ear, slide the slider up and down so that the earpads cover the ears, and then adjust the headband.

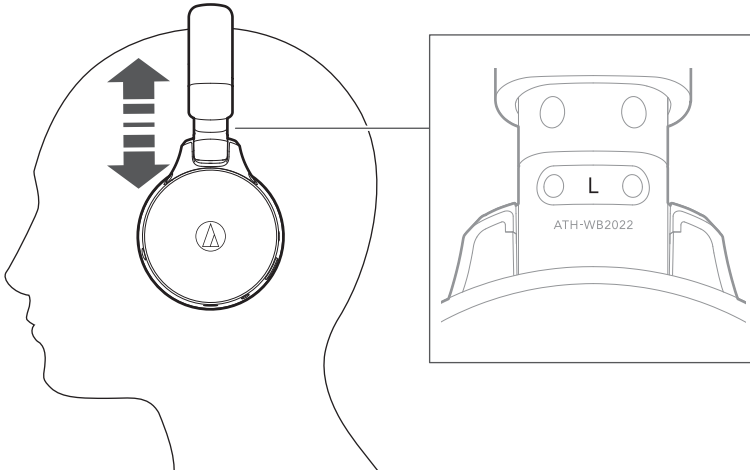

## Swivel mechanism

You can fold the housing so that it lies flat.

- The swivel mechanism cannot rotate more than 90 degrees. Do not apply excessive force.

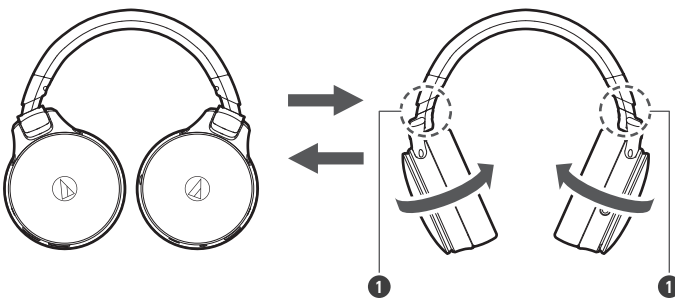

**1** Joint

# Using the product (Bluetooth connection)

The product can use Bluetooth wireless technology to connect to your device and play music, receive phone calls, etc. Use the product for whichever of these purposes suits your needs. Note that Audio-Technica cannot guarantee the operation of displays, such as the battery level display, or applications via Bluetooth devices.

## Listening to music

- To connect for the first time, pair the product and your device via Bluetooth wireless technology. If you have already paired the product and your Bluetooth device, turn on the Bluetooth device's Bluetooth connection before turning on the product.
- Use your Bluetooth device to start playback, referring to the device's user manual as necessary.

**1 Turn on the product and place the product on your ears.**

**2 Start music playback on your Bluetooth device.**

**3 Adjust the volume by pressing the volume buttons (+/-).**



**4 Press the multifunction button to pause playback.**

- Playback will be started or paused with every press.

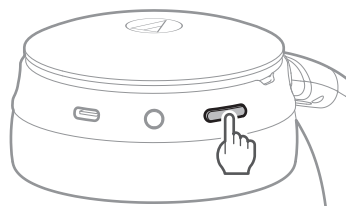

## Using the product (Bluetooth connection)

### Multifunction button operation

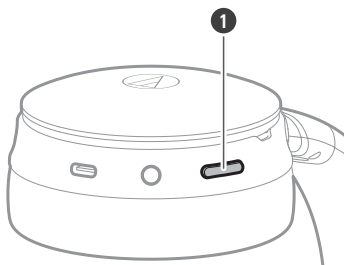

1 Multifunction button

Operation	Function
Press	Starts or pauses playback.
Press (twice)	Plays the next track.
Press (three times)	Plays the previous track / returns to the start of the track.
Press and hold (about 2 seconds)	Depending on the connected device, activates the device's speech recognition feature (such as Siri for compatible iOS devices).

- The controls explained above may not be available on some smartphones.

### Volume button operation

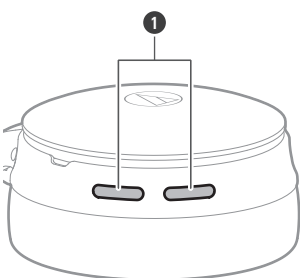

1 Volume buttons

Operation	Function
Press	Increases/decreases the volume by 1 level. <sup>[1][2]</sup>
Press and hold	Increases/decreases the volume continuously. <sup>[1][2]</sup>

[1] The voice guidance is played when the volume is at the maximum or minimum level.

[2] The volume control of some Bluetooth devices may not work well with the product.

- The controls explained above may not be available on some smartphones.

## Using the product (Bluetooth connection)

### Talking on the phone

If your Bluetooth device supports telephone features, you can use the product to talk on the phone.

**1 Turn on the product and place the product on your ears.**

**2 Make/receive calls with your Bluetooth device.**

- When your Bluetooth device receives a phone call, the product sounds a ringtone.
- If a call is received while you are listening to music, music playback is paused.

**3 Adjust the volume by pressing the volume buttons (+/-).**



**4 Press and hold the multifunction button (about 2 seconds) to end a call.**

- If the call was received while listening to music, playback is resumed.
- Music playback may not be resumed on some Bluetooth devices. In this case, music playback must be started manually.



- Not wearing the product properly while talking on the phone may cause your voice to be too quiet for others to hear.

## Using the product (Bluetooth connection)

### Multifunction button operation

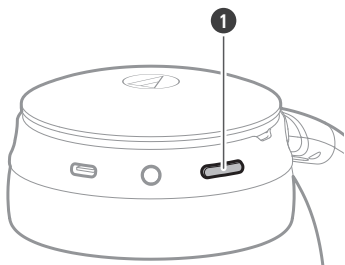

1 Multifunction button

Operation	Function
Press	Receiving a call: Answers the call.
Press (twice)	During a call: Switches the microphone mute on/off. <sup>[1]</sup>
Press and hold (about 2 seconds)	Receiving a call: Rejects the call. Making a call: Cancels the call. During a call: Ends the call.

[1] The mute operation using the multifunction button only mutes the headphones and does not activate the mute function on the Bluetooth device.

- The controls explained above may not be available on some smartphones.

### Volume button operation

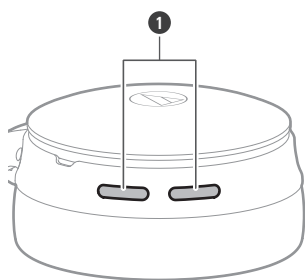

1 Volume buttons

Operation	Function
Press	Increases/decreases the volume by 1 level. <sup>[1][2]</sup>
Press and hold	Increases/decreases the volume continuously. <sup>[1][2]</sup>

[1] The voice guidance is played when the volume is at the maximum or minimum level.

[2] The volume control of some Bluetooth devices may not work well with the product.

- The controls explained above may not be available on some smartphones.

## Using the product (Bluetooth connection)

### Auto power off function

The product automatically turns off after 5 minutes of not being connected to a device.

### App for smartphones

This product is compatible with our “CONNECT” app. The app gives you convenient access to various functions. It also allows you to update the product’s firmware.

<https://app.at-globalsupport.com>



#### **CONNECT App**

iOS, Android

### What you can do with the app

The app allows you to use the following functions. For details, refer to the app screen.

Function	Description
Volume Adjustment Level	You can adjust volume in levels during music playback.
Audio Codecs <sup>[1]</sup>	You can change the connection codec.
Equalizer	You can adjust the equalizer settings.
Low Latency Mode (OFF at the time of purchase)	Low latency mode reduces sound delay when playing games or watching videos. Bluetooth communication can be easily affected by obstacles and radio wave conditions. Turn this mode off in such situations.
Connected Device Management	You can switch the connection by selecting the Bluetooth device you want to connect from the list of Bluetooth devices you have connected to so far.

[1] Changes can only be made on Android devices.

# Using the product (USB audio mode)

The product is equipped with USB audio mode to play back music with a wired connection.

- The buttons on the product are not operational when using a wired connection.
- Our “CONNECT” app cannot be used when using a wired connection.
- The product will not pick up your voice when using USB audio mode.
- Use the appropriate exclusive USB cable for the connected device’s terminal (either USB Type-A / USB Type-C or USB Type-C / USB Type-C).

## 1 Connect the included exclusive USB cable (USB Type-C side) to the battery jack.

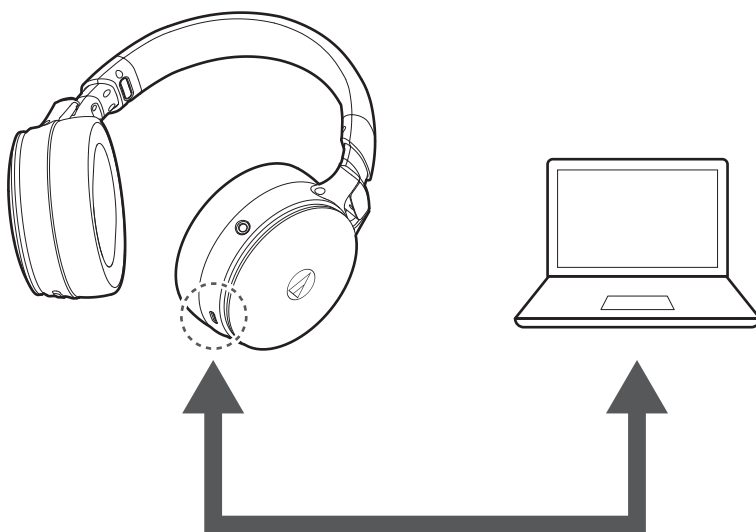

## 2 Connect the included exclusive USB cable to the computer.

## 3 Press and hold the power supply / control button (about 2 seconds).

- The first time the product is connected, the computer will automatically recognize it and install the driver.

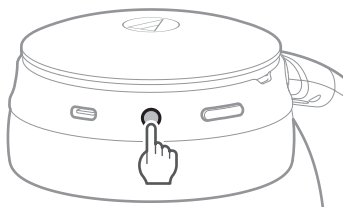

» The indicator lamp will light in blue, and then the product will switch to USB audio mode.

## 4 Configure the settings on the computer.

- For details on Windows settings, refer to "Computer settings (Windows)" (p. 22). For details on macOS settings, refer to "Computer settings (macOS Catalina, macOS Big Sur, macOS Monterey)" (p. 31).

## 5 Place the product on your head.

## Using the product (USB audio mode)

### 6 Start music playback on your computer.



- After starting the music player program on your computer, music may not play on the product if you use a wired connection. In this case, close your music player program and then restart it.



- The first time you connect to your computer in USB audio mode, the computer volume is set to the highest level. To prevent damage to your hearing, turn the volume down. Listening to loud sound for an extended period may cause temporary or permanent hearing loss.

## Computer settings (Windows)

### For Windows 11

Check if this product is correctly recognized by your computer.

- 1 Open the Start Menu and select “Settings”.
- 2 Select “System”.
- 3 Select “Sound”.
- 4 In “Output”, confirm that this product is selected.

## Using the product (USB audio mode)

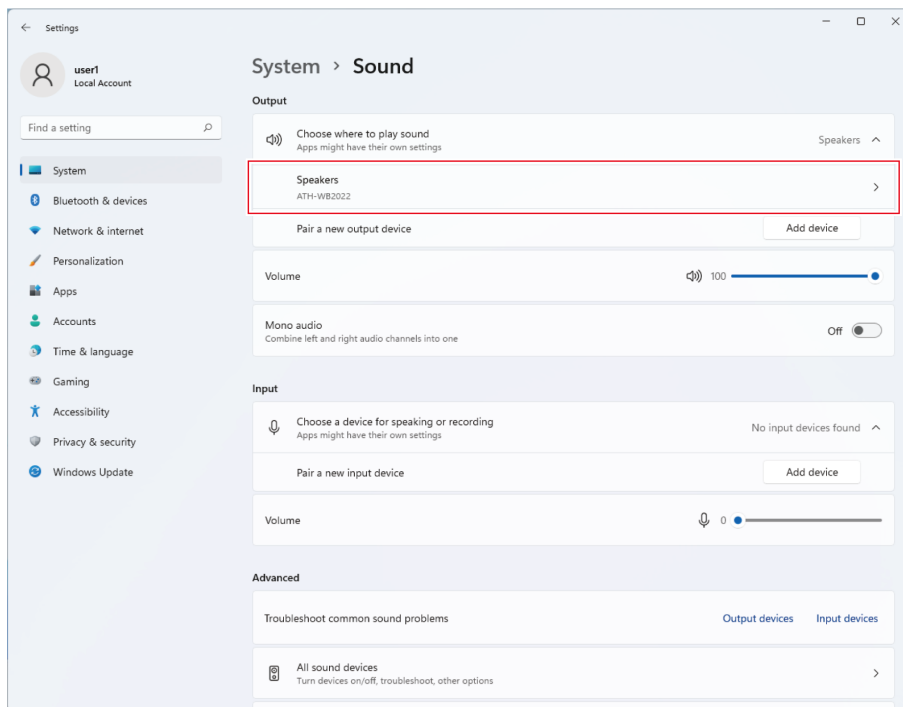

### Advanced sound settings

Configure the following settings to change the volume and sample rate.

- 1 In the "Sound" window, select "More sound settings".

## Using the product (USB audio mode)

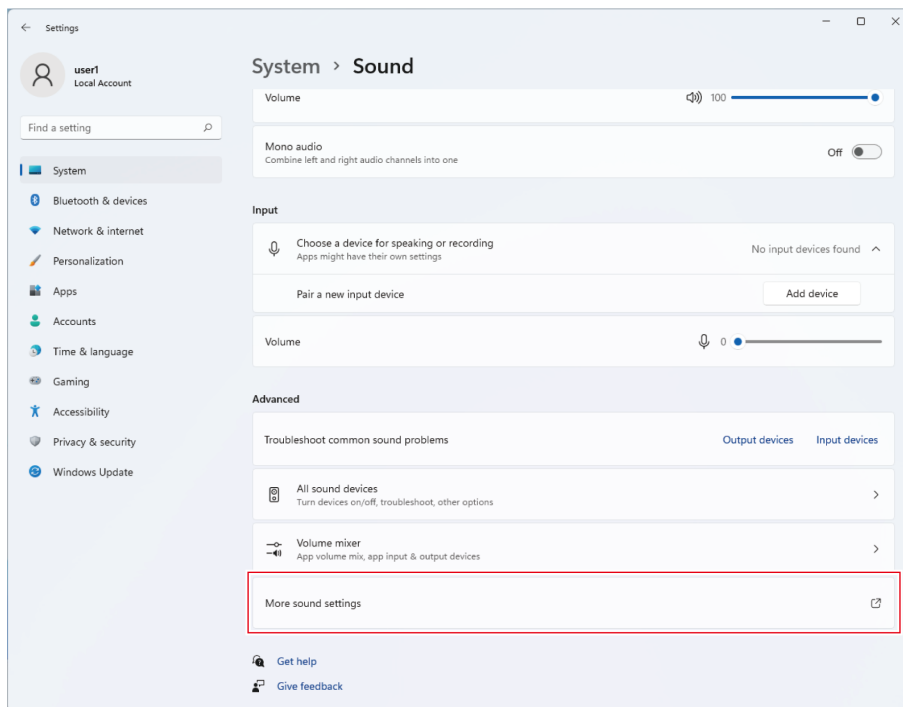

## 2 On the “Playback” tab, confirm that this product is selected.

- If this product is not selected, select it and click “Set Default”.

## Using the product (USB audio mode)

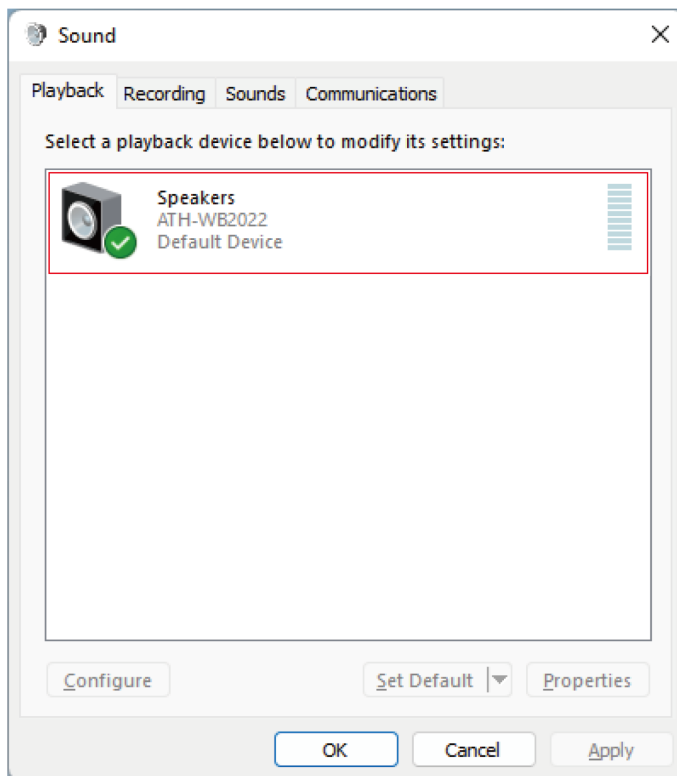

**3** Double-click the product icon and open the properties.

**4** Select the “Levels” tab, confirm that the headphone speaker icon is on, configure the main volume, and then click “OK”.

- If it is not on, click the speaker icon and turn it on.
- You can also adjust the volume with your music player program.

## Using the product (USB audio mode)

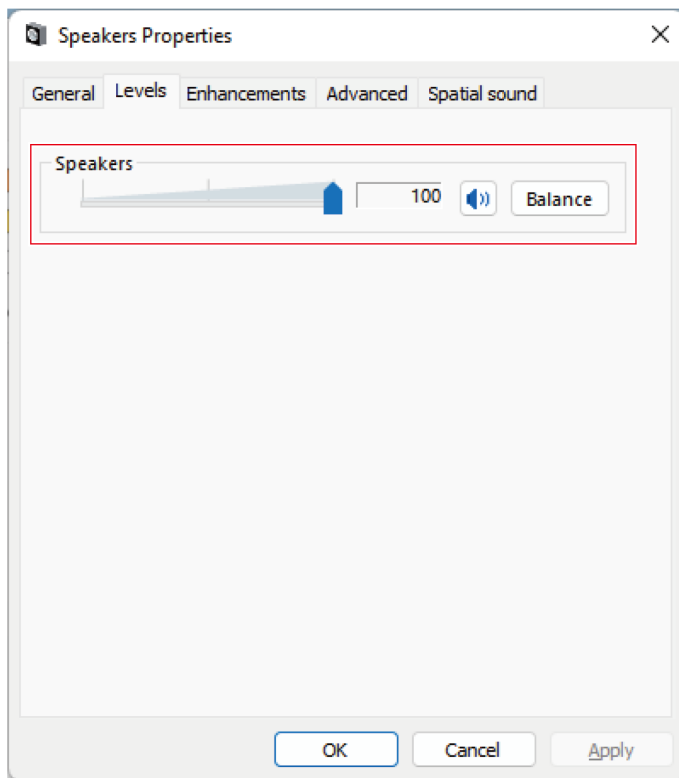

- 5 Select the “Advanced” tab, configure the audio quality, and then select “Apply”.

## Using the product (USB audio mode)

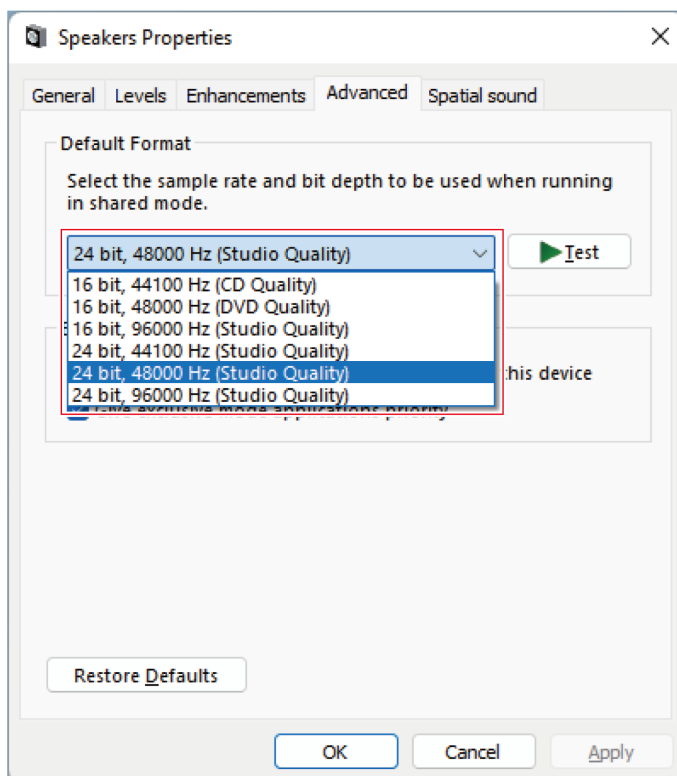

**6** When the following message appears, click “Yes”.

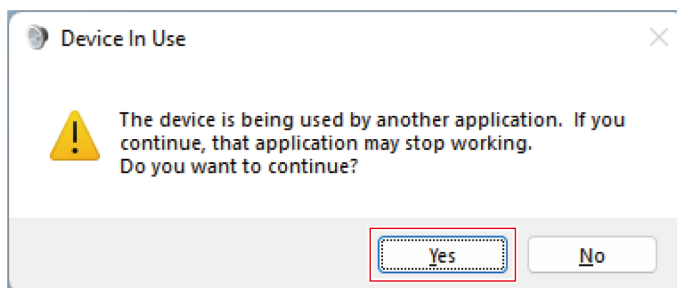

**7** Click “OK”.

## For Windows 10

Check if this product is correctly recognized by your computer.

**1** Open the Start Menu and select “Settings”.

**2** Select “System”.

## Using the product (USB audio mode)

**3** Select “Sound”.

**4** In “Output”, confirm that this product is selected.

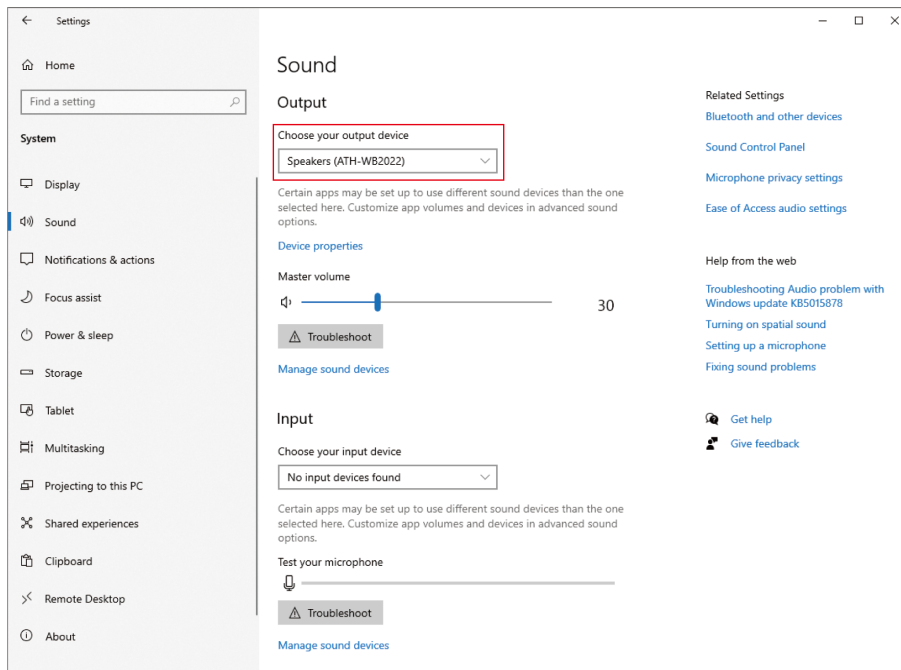

## Advanced sound settings

Configure the following settings to change the volume and sample rate.

**1** In the “Sound” window, select “Sound Control Panel”.

## Using the product (USB audio mode)

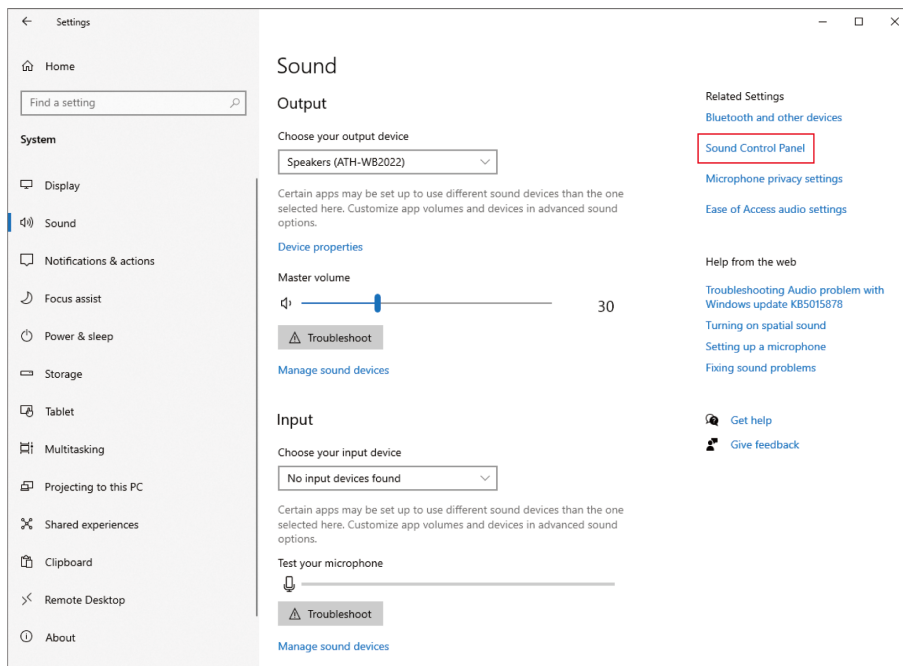

## 2 On the “Playback” tab, confirm that this product is selected.

- If this product is not selected, select it and click “Set Default”.

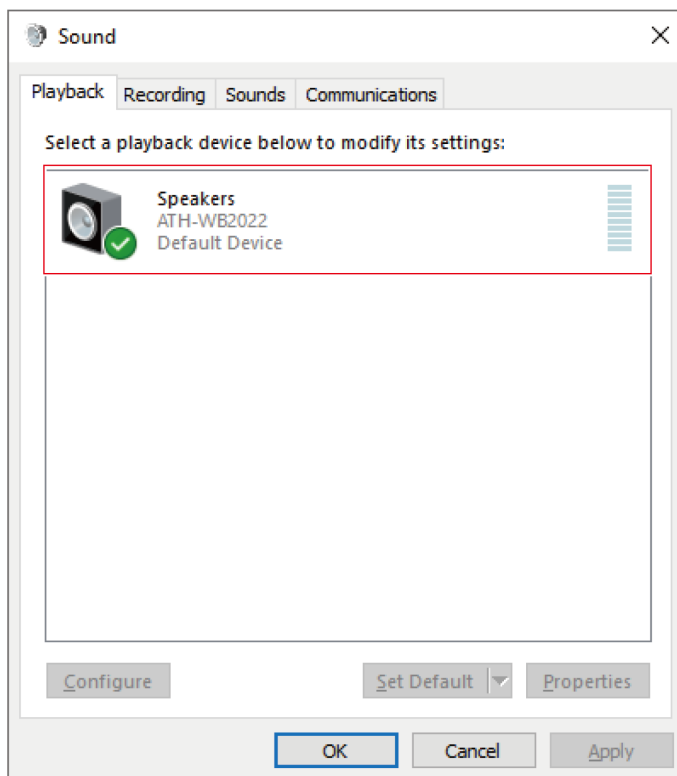

## Using the product (USB audio mode)

**3** Double-click the product icon and open the properties.

**4** Select the “Levels” tab, confirm that the headphone speaker icon is on, configure the main volume, and then click “OK”.

- If it is not on, click the speaker icon and turn it on.
- You can also adjust the volume with your music player program.

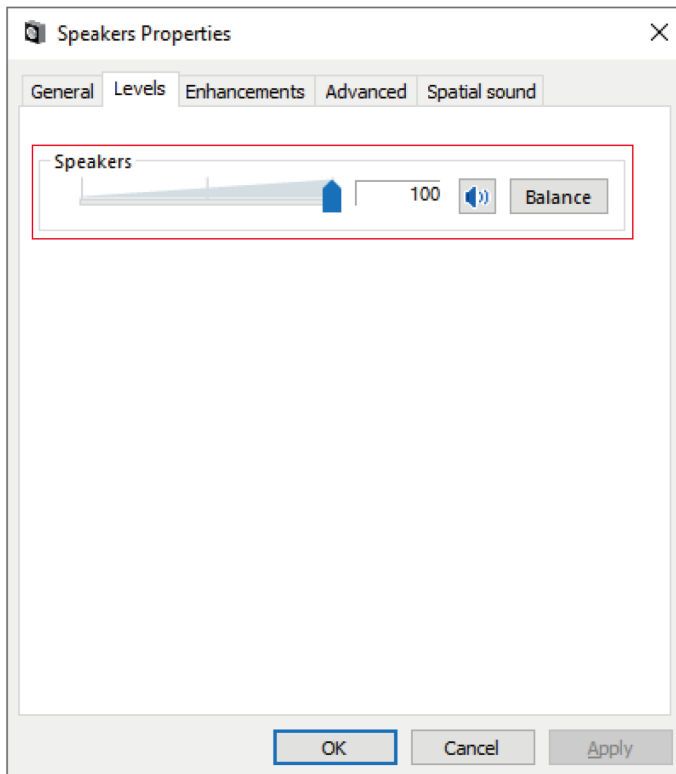

**5** Select the “Advanced” tab, configure the audio quality, and then select “Apply”.

## Using the product (USB audio mode)

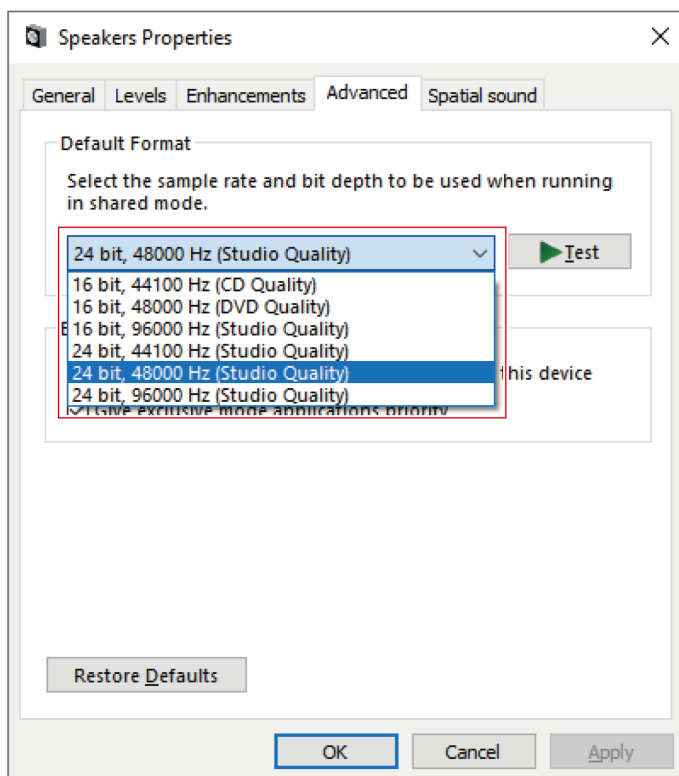

**6** When the following message appears, click “Yes”.

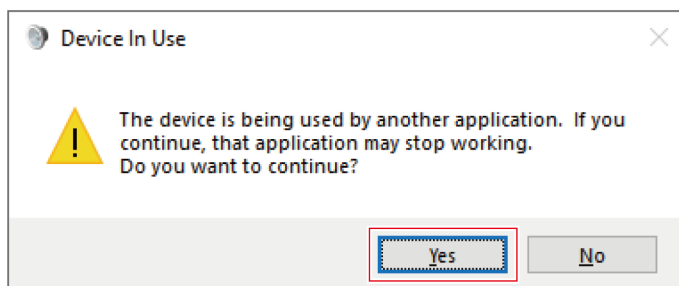

**7** Click “OK”.

## Computer settings (macOS Catalina, macOS Big Sur, macOS Monterey)

Check if this product is correctly recognized by your computer.

## Using the product (USB audio mode)

- 1 Click the Apple icon and select “System Preferences”.
- 2 Click “Sound”.
- 3 On the “Output” tab, confirm that this product is selected.
  - You can set the left-right volume balance in “Balance”.
  - In “Output volume”, adjust the playback output volume from your computer.

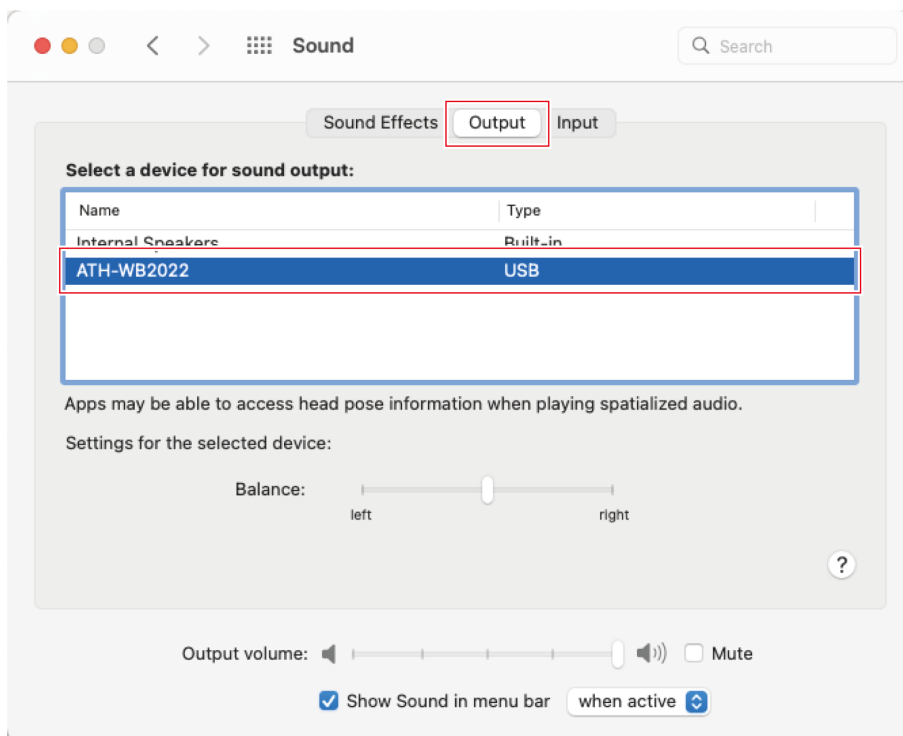

### Advanced sound settings

Configure the following settings to change the sample rate.

- 1 Open the “Applications” folder, the “Utilities” folder, and “Audio MIDI Setup”.
- 2 Select this product in “Audio Devices”, and then select the sampling rate and bit rate.

## Using the product (USB audio mode)

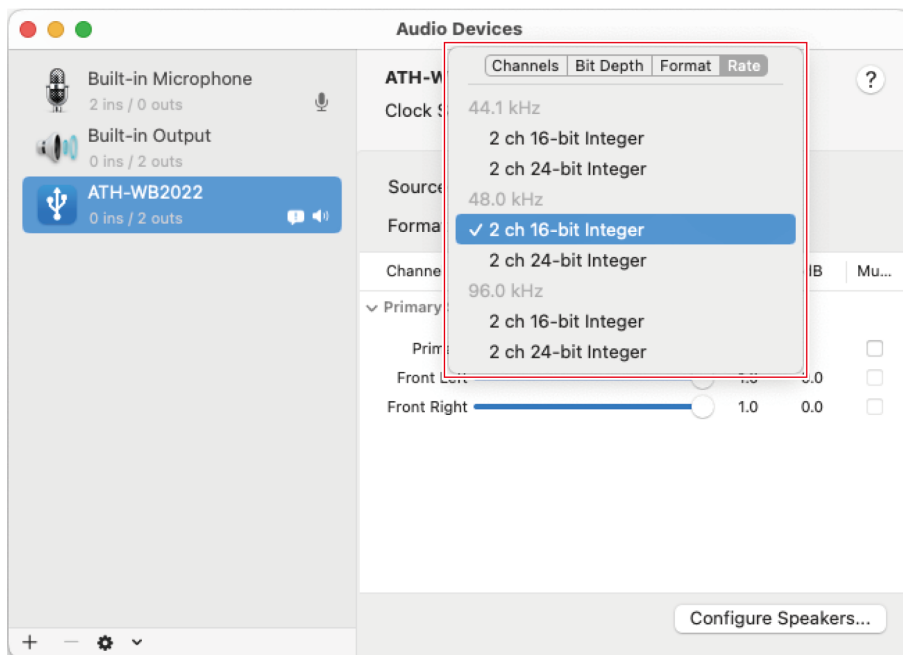

- If the L/R (left/right) volume sounds different when this product is connected, check if the "Front Left" and "Front Right" values are the same in the "Audio Devices" window.

# Indicator lamp display

The indicator lamp of the product indicates the product's status.

## Pairing

Status	Indicator lamp display pattern
Searching for devices	○ - ○ - ○ . . . Flashing white (gradually lighting up)

## Connecting

Status	Indicator lamp display pattern
Connecting	○-----○-----○ . . . Flashing white in 5-second intervals
Music is playing	Off

## USB audio mode

Status	Indicator lamp display pattern
USB audio mode ON	 Lights in blue

## Charging

Status	Indicator lamp display pattern
Charging	○ Lights in white
Fully charged	Off
Charging error	○ - ○ - ○ . . . Flashing white (It may flash in bluish white. In this case, reset the product.)

# Voice guidance

The product plays English voice guidance in the following situations.

Situation	Voice guidance
Bluetooth is connected	Connected
Bluetooth is disconnected	Disconnected
Low latency mode ON	Low latency
Low latency mode OFF	Low latency off
Maximum volume	Max
Minimum volume	Minimum
Battery level is low	Low battery
No power due to dead battery	Please recharge

# Cleaning

Get into the habit of regularly cleaning the product to ensure that it will last for a long time. Do not use alcohol, paint thinners, or other solvents for cleaning purposes.

- Use a dry cloth to clean the headphones.
- To clean the earpads and headband, wipe with a dry cloth. Earpads and headband may fade if sweat or water dries on them. If the earpads and headband get wet, we recommend wiping them with a dry cloth and allowing them to dry in the shade.
- Immediately wipe off any moisture such as sweat from operating areas such as the buttons. Failure to do so may result in a malfunction due to corrosion.
- Wipe away any perspiration or dirt from the cable with a dry cloth immediately after use. Failure to clean the cable may cause it to deteriorate and harden over time, resulting in malfunction.
- Wipe the cable's USB plug with a dry cloth if dirty.



- If the product will not be used for an extended period of time, store it in a well-ventilated place free from high temperatures and humidity.
- Earpads are consumable parts. The earpads deteriorate over time due to use or storage. Contact your local Audio-Technica dealer for earpad replacement or other repairs.

# Forced pairing mode / reset

## If the product does not connect to a device (forced pairing mode)

If pairing cannot be cancelled or is not successful, you can use forced pairing mode to perform pairing again.

- 1** With the product turned on, press and hold (about 6 seconds) the volume buttons (+/-) at the same time.



» After the indicator lamp lights in bluish white, the product will switch to the "searching for devices" (pairing mode) state and you will be able to pair with your desired Bluetooth device.

## If the product operates abnormally (reset)

Reset the product.

- 1** With the product turned on and not connected with a Bluetooth device, press and hold (about 6 seconds) the multifunction button and volume button (+) at the same time.



» After the indicator lamp lights in bluish white, the product will restart, and the reset will be complete.

- 2** Remove the product from the list of registered devices on your Bluetooth device.
- 3** Pair the product again.

# Troubleshooting

## **Power is not supplied**

- Charge the product.

## **Unable to pair**

- Confirm that the Bluetooth device communicates using Ver. 2.1+EDR or higher.
- Place the product and the Bluetooth device within 1 m (3.3') of each other.
- Set the profiles for the Bluetooth device. For procedures on how to set profiles, refer to the Bluetooth device's user manual.
- Remove the pairing information for the Bluetooth device then pair the product with this device again.
- Make sure you are not connected to any other previously connected Bluetooth device. If so, disconnect the product using the previously connected Bluetooth device, and then select the product on the Bluetooth device being connected to. Use forced pairing mode if you are unable to disconnect from a previously connected Bluetooth device. For details, refer to "If the product does not connect to a device (forced pairing mode)" (p. 37).
- Reset the product if it cannot be unpaired, connected, or does not operate as expected even after trying all other solutions. For details, refer to "If the product operates abnormally (reset)" (p. 37).

## **No sound is heard / Sound is faint**

- Turn on the power of the product and the Bluetooth device.
- Turn up the volume on the product and the Bluetooth device.
- Make sure that the product and Bluetooth device are connected by the A2DP (or audio connection).
- Disable pairing for the product and the Bluetooth device, then pair the product with this device again.
- Move away from obstacles between the product and the Bluetooth device, such as people, metal, or walls, and place the product and device closer together.
- Switch the sound output of the Bluetooth device to the product.

## **No sound is heard / sound is faint during USB audio mode**

- Make sure the computer's audio output settings are correct.
- Turn up the volume of your computer or your music player program.

## **Sound is distorted / Noise is heard / Sound cuts out**

- Turn down the volume on the product and the Bluetooth device.
- Keep the product away from devices that emit radio waves such as microwaves and wireless routers.

## Troubleshooting

- Keep the product away from TVs, radios, and devices with built-in tuners. These devices can also be affected by the product.
- Turn off the equalizer settings of the Bluetooth device.
- Remove obstacles between the product and the Bluetooth device and place them closer together. For details, refer to "For a more comfortable Bluetooth communication experience" (p. 5).



### **Sound is distorted / noise is heard / sound cuts out during USB audio mode**

- Turn down the volume of your computer or your music player program.
- Turn off the equalizer settings of your music player program.



### **Cannot hear the voice of the caller / Voice of the caller is too quiet**

- Turn on the power of the product and the Bluetooth device.
- Turn up the volume on the product and the Bluetooth device.
- Confirm that the product and Bluetooth device are connected via HFP/HSP (or phone connection).
- Disable pairing for the product and the Bluetooth device, then pair the product with this device again.
- Switch the sound output of the Bluetooth device to the product.



### **My voice is too quiet for others to hear**

- Wear the product properly. Not wearing the product properly while talking on the phone may cause your voice to be too quiet for others to hear.



### **The product cannot be charged**

- Securely connect the included exclusive USB cable and charge the product.
- Charge the product in a well-ventilated place (10 to 35°C (50 to 95°F)) away from direct sunlight.



### **The volume sounds different from the left and right sides when listening to music in USB audio mode**

- When connecting the product to macOS, the L/R (left/right) volume may sound different. In this case, check if the "Front Left" and "Front Right" values are the same in the "Audio Devices" window. For details, refer to "Advanced sound settings" (p. 32).



- For details about how to operate your Bluetooth device, refer to the device's user manual.

# Specifications

## Headphones

Type	Closed-back dynamic
Driver	45 mm
Sensitivity	106 dB/mW
Frequency response	5 to 45,000 Hz
Impedance	47 ohms

## Microphone

Type	Electret condenser
Polar pattern	Omnidirectional
Sensitivity	-35 dB (1 V/Pa, at 1 kHz)
Frequency response	60 to 20,000 Hz

## Communication specifications

Communication system	Bluetooth version 5.1
Maximum RF output	10 mW EIRP
Maximum communication range	Line of sight - approx. 10 m (33')
Frequency band	2.402 GHz to 2.480 GHz
Modulation method	GFSK, Pi/4DQPSK, 8DPSK
Spread spectrum method	FHSS
Compatible Bluetooth profiles	A2DP, AVRCP, HFP
Supported codec	LDAC, AAC, SBC
Supported content protection method	SCMS-T
Supported sample rates	44.1 kHz, 48 kHz, 88.2 kHz, 96 kHz
Supported bit rates	16-bit, 24-bit
Transmission band	20 to 40,000 Hz (when LDAC 96 kHz sampling, 990 kbps) 20 to 20,000 Hz (when 44.1 kHz sampling)

### USB audio mode specifications

<b>System requirements</b>	Compliant with USB 2.0
<b>CPU</b>	Intel Core 2 processor running at 2.2 GHz or faster, or an equivalent AMD processor
<b>RAM</b>	2 GB or more for 32-bit OS, 4 GB or more for 64-bit OS
<b>Supported operating systems</b>	Windows 10, Windows 11 macOS Catalina, macOS Big Sur, macOS Monterey (Visit our website for the latest information about the product.)
<b>Supported sample rates</b>	44.1 kHz, 48 kHz, 96 kHz
<b>Supported bit rates</b>	16-bit, 24-bit
<b>Frequency response</b>	5 to 45,000 Hz (during 24-bit, 96 kHz playback)

### Other

<b>Power supply</b>	DC 3.7 V lithium ion battery
<b>Charging time</b>	Approx. 2.5 hours <sup>[1]</sup>
<b>Operating time</b>	Continuous transmission time (music playback): Max. approx. 9 hours <sup>[1]</sup>
<b>Weight</b>	Approx. 350 g (12 oz)
<b>Operating temperature</b>	5°C to 40°C (41°F to 104°F)
<b>Accessories</b>	Exclusive USB cable (1.5 m (4.9')), USB Type-A / USB Type-C), Exclusive USB cable (1.5 m (4.9')), USB Type-C / USB Type-C), Pouch (for storing cables), Case
<b>Sold separately</b>	Exclusive USB cable

[1] The figures above depend on operating conditions.

- For product improvement, the product is subject to modification without notice.

# Trademarks

- The **Bluetooth**<sup>®</sup> word mark and logos are registered trademarks owned by Bluetooth SIG, Inc., and any use of such marks by Audio-Technica Corporation is under license. Other trademarks and trade names are those of their respective owners.
- USB Type-C<sup>™</sup> is a trademark of USB Implementers Forum.
- Microsoft<sup>®</sup> and Windows<sup>®</sup> are registered trademarks of Microsoft Corporation in the United States and/or other countries.
- Microsoft Windows operating system is indicated in its abbreviated form as Windows.
- Mac, macOS, and Siri are trademarks of Apple Inc., registered in the U.S. and other countries.
- LDAC<sup>™</sup> and LDAC logos are trademarks of Sony Corporation.



**株式会社オーディオテクニカ**

〒194-8666 東京都町田市西成瀬2-46-1  
[www.audio-technica.co.jp](http://www.audio-technica.co.jp)

**Audio-Technica Corporation**

2-46-1 Nishi-naruse, Machida, Tokyo 194-8666, Japan  
[www.audio-technica.com](http://www.audio-technica.com)  
©2023 Audio-Technica Corporation  
Global Support Contact: [www.at-globalsupport.com](http://www.at-globalsupport.com)