

**BC701****User Manual / Battery Charger****audio-technica**

Thank you for purchasing this Audio-Technica product. Before using the product, please read through the Quick Start Guide, as well as this user manual when necessary, to ensure that you can use the product correctly.



- **Quickly charges two connected devices such as rechargeable infrared wireless microphones and transmitters**
- **Integral indicator lamp shows the battery level as calculated by a microcomputer**
- **Lightweight and compact design***
 - * **Approx. 15% lighter compared to conventional models (excluding the AC adapter)**
- **Replaceable charging unit**

* This product must be used in combination with an Audio-Technica microphone and/or transmitter sold separately.

Visit our web site for information on compatible models.

Important information

Warning:

- To prevent fire or shock hazard, do not expose this apparatus to rain or moisture.

Caution:

- Do not expose this apparatus to drips or splashes.
- To avoid electric shock, do not open the cabinet.
- Refer servicing to qualified personnel only.
- Do not expose this apparatus to excessive heat such as that generated by sunshine, fire or other heat sources.
- Do not subject this apparatus to strong impact.
- This apparatus should be located close enough to the AC outlet so that you can easily grasp the AC adapter at any time.
- In case of emergency, disconnect the AC adapter quickly.
- Do not place any objects filled with liquids, such as vases, on this apparatus.
- To prevent fire, do not place any naked flame sources (such as lighted candles) on this apparatus.
- Do not install this apparatus in a confined space such as a bookcase or similar unit.
- Install this apparatus only in the places with good ventilation.
- The rating label is put on the bottom of this apparatus.

Important Safety Instructions

- 1) Read these instructions.
- 2) Keep these instructions.
- 3) Heed all warnings.
- 4) Follow all instructions.
- 5) Do not use this apparatus near water.
- 6) Clean only with dry cloth.
- 7) Do not block any of the ventilation openings. Install in accordance with the manufacturer's instructions.
- 8) Do not defeat the safety purpose of the polarized or grounding plug.
A polarized plug has two blades with one wider than the other.
A grounding plug has two blades and a third grounding prong.
The wide blade or the third prong is provided for your safety. If the provided plug does not fit into your outlet, consult an electrician for replacement of the obsolete outlet.
- 9) Protect the power cord from being walked on or pinched particularly at plugs, convenience receptacles, and the point where they exit from the apparatus.

10) Only use attachments/accessories specified by the manufacturer.

- 11) Use only with a cart, stand, tripod, bracket, or table specified by the manufacturer, or sold with the apparatus.
When a cart is used, use caution when moving the cart/apparatus combination to avoid injury from tip-over.



12) Unplug this apparatus during lightning storms or when unused for long periods of time.

- 13) Refer all servicing to qualified service personnel. Servicing is required when the apparatus has been damaged in any way, such as power-supply cord or plug is damaged, liquid has been spilled or objects have fallen into the apparatus, the apparatus has been exposed to rain or moisture, does not operate normally, or has been dropped.

FCC Notice**Warning:**

This device complies with Part 15 of the FCC Rules. Operation is subject to the following two conditions: (1) This device may not cause harmful interference, and (2) this device must accept any interference received, including interference that may cause undesired operation.

Caution:

You are cautioned that any changes or modifications not expressly approved in this manual could void your authority to operate this equipment.

Note:

This equipment has been tested and found to comply with the limits for a Class B digital device, pursuant to part 15 of the FCC Rules. These limits are designed to provide reasonable protection against harmful interference in a residential installation. This equipment generates, uses and can radiate radio frequency energy and, if not installed and used in accordance with the instructions, may cause harmful interference to radio communications. However, there is no guarantee that interference will not occur in a particular installation.

If this equipment does cause harmful interference to radio or television reception, which can be determined by turning the equipment off and on, the user is encouraged to try to correct the interference by one or more of the following measures:

- Reorient or relocate the receiving antenna.
- Increase the separation between the equipment and receiver.
- Connect the equipment into an outlet on a circuit different from that to which the receiver is connected.
- Consult the dealer or an experienced radio/TV technician for help.

Notes on use

- Use this product on a flat surface when charging. Battery cannot be charged when this product is tilted.
- Start charging after turning off the power switch of the device to be charged. You may hear an unusual sound when you connect a device that is still turned on. However, there is no problem with use.
- Repeated charging without using up the charge in the rechargeable battery causes a memory effect where battery drain occurs irrespective of the charged state. Start charging only after using up the charge, which is when the indicator lamp of the device turns off. If the problem still persists, the rechargeable battery may have reached the end of its life. In such a case, replace it with a new rechargeable battery.
- When using this product as a stand without charging, disconnect the AC adapter.
- The AC adapter generates heat while charging. Do not place this product near the AC adapter or any other place that may have high temperatures. Rechargeable battery may not be fully charged.
- Repeated charging of the rechargeable battery causes the maximum capacity of the battery to drop.
When the effective battery time starts getting shorter, a battery replacement is recommended.
- Disconnecting the device being charged and reconnecting will cause the battery level check to take about 30 minutes.
The battery Indicator lamp will turn red during this time.
- If the charging terminal on the bottom of the device is dirty, the battery may not be charged properly.
Connect the device to this product after cleaning the charging terminal.
- A new rechargeable battery may not last long during the first few charge-discharge cycles. This is not a malfunction.
In such a case, after fully charging the battery, use up the charge completely and recharge the battery.
Repeating this process one to four times depending on the condition of the battery can restore the battery's performance.

Part names and functions / How to charge

* Also read the user manual for Audio-Technica microphone or transmitter sold separately.

* This product can charge two devices at the same time.

- (1) Connect the AC adapter to the external power supply input jack (12 V DC IN) located at the bottom of this product.

* Route the DC cable in the groove for the cable and extend it out of the port.

* DC cable can be extended out from any of the four locations.

Use whichever of these that suits your needs.

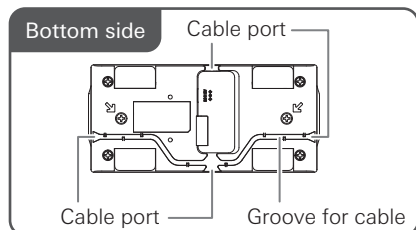

- (2) Connect the AC adapter to the outlet.

When connected, the power supply indicator lamp (POWER) lights up red.

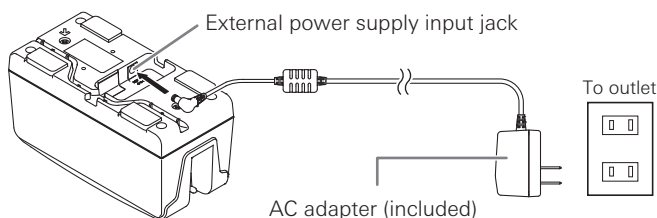

- (3) Turn off the power of the device to be charged and connect it to the charging port.

■ Example of use

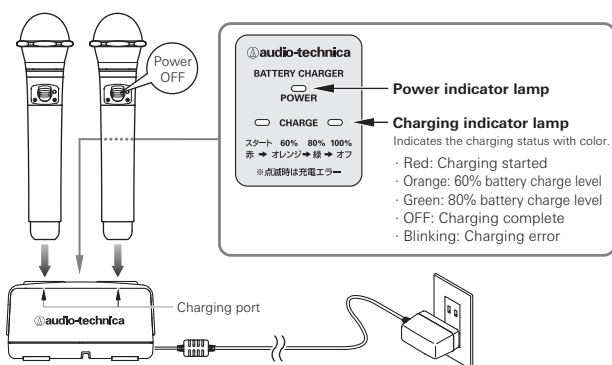

* Connect the device to the charger and if the charging indicator lamp blinks, there may be an error. Turn off the power to this product and try again. If the indicator lamp still blinks after turning off and on this product, the rechargeable battery may have reached the end of its life. In such a case, replace with a new rechargeable battery.

* When a device is connected to the charging port while it is powered on, the device turns off automatically and charging starts. (Auto OFF function)

- (4) While a device is being charged, the charging indicator lamp changes according to the charging status.
(Red → Orange → Green)

- (5) Charging is complete when the charging indicator lamp turns off.

* Audio-Technica nickel-metal hydride battery (1900 mAh) takes **about 5.5 hours** to complete charging.

* Audio-Technica nickel-metal hydride battery (1900 mAh) lasts about 1 year with proper use or for about 750 charging cycles.

* The indicated charge level is for reference only. Use your device after it is fully charged (charging indicator lamp turns off) whenever possible.

* If only a small amount of charge had been drained from the rechargeable battery, the charging quickly completes automatically.

Replacing the charging unit

* When a replacement of charging unit is necessary due to a malfunction, replace the charging unit as per the following procedure.

* Charging unit replacements are sold separately.

- (1) Turn off the power and remove the AC adapter.
- (2) Remove the 2 screws indicated by an arrow on the bottom side.

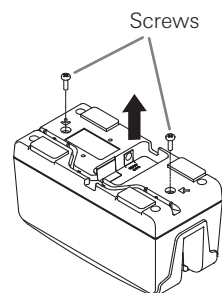

- (3) Remove the charging unit from the main unit.

- (4) Disconnect the lead wire connector from the connector on the charging unit side. Replace the charging unit.

* Hold the base of the connector when disconnecting the connector.

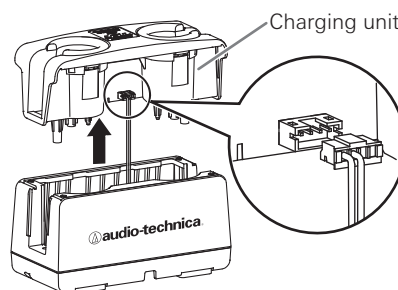

- (5) Attach the charging unit to the main unit.

* Ensure that the lead wire is not caught when attaching the charging unit.

- (6) Tighten the 2 screws into the holes on the bottom side.

Specifications

Type	: Quick charge
Power supply	: 12 V DC, 500 mA (use the included AC adapter)
Charge output	: 3.5 V DC, 400 mA × 2
Power consumption	: 5.5 W (charging)
Rechargeable battery standard charging time:	About 5.5 hours* (with Audio-Technica nickel-metal hydride battery (1900 mAh))
Dimensions	: 80 (H) × 151 (W) × 70 (D) mm
Weight	: Approx. 370 g
Rechargeable battery operating temperature:	Discharge (when using device): -10°C to 40°C Storage: -20°C to 40°C Charging: 5°C to 40°C
Accessories	: AC adapter (AD-SA1205AA)

* Depends on the remaining battery charge level of the rechargeable battery.
The product is subject to modification without notice for product improvement.